

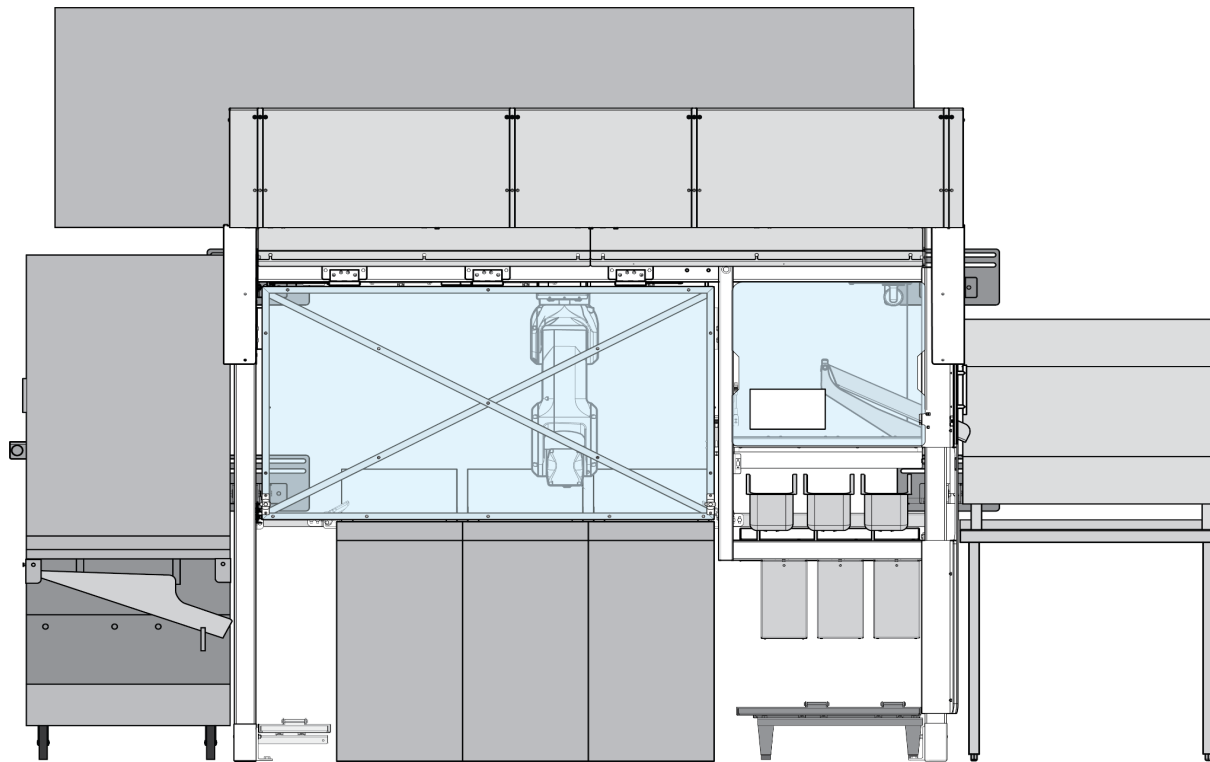

# MISO ROBOTICS

## Spec Sheet for Canopy Hood - 3 Fryer - Left to Right Flow

Congratulations on being one step closer to having a Flippy 2 in your kitchen!



## CONTENTS

<b>INTRODUCTION TO FLIPPY 2</b>	<b>3</b>
<b>SPACE REQUIREMENTS</b>	<b>8</b>
<b>CANOPY HOOD COMPATIBILITY</b>	<b>9</b>
<b>MOUNTING REQUIREMENTS</b>	<b>10</b>
<b>POWER &amp; ETHERNET PORT CONNECTION REQUIREMENTS</b>	<b>12</b>
<b>NETWORK REQUIREMENTS</b>	<b>13</b>
<b>FOOD DISPENSER SPECIFICATIONS</b>	<b>15</b>
<b>HOT HOLD SPECIFICATIONS</b>	<b>16</b>
<b>HOT HOLD PLACEMENT REQUIREMENTS</b>	<b>19</b>

### A Few Notes:

- Miso Robotics provides the Food Dispenser
- Miso Robotics does not provide the Hot Hold unit but recommend the Hatco Multi-Product Warming Station
  - ◆ **[MODEL: MPWS-36]**
  - ◆ Hot Hold station has accessories to customize and accommodate your workflow preferences

## INTRODUCTION TO FLIPPY 2

### FLIPPY 2 PRODUCES DRAMATIC RESULTS

 **PAYS FOR  
ITSELF**

 **UNMATCHED  
QUALITY AND  
CONSISTENCY**

 **BETTER  
REVENUE  
POTENTIAL**

 **INCREASED  
THROUGHPUT**

 **IMPROVES  
SPEED OF  
SERVICE**

Case studies available! Contact us to learn more.

[MisoRobotics.com/GetFlippy](https://www.misorobotics.com/GetFlippy)



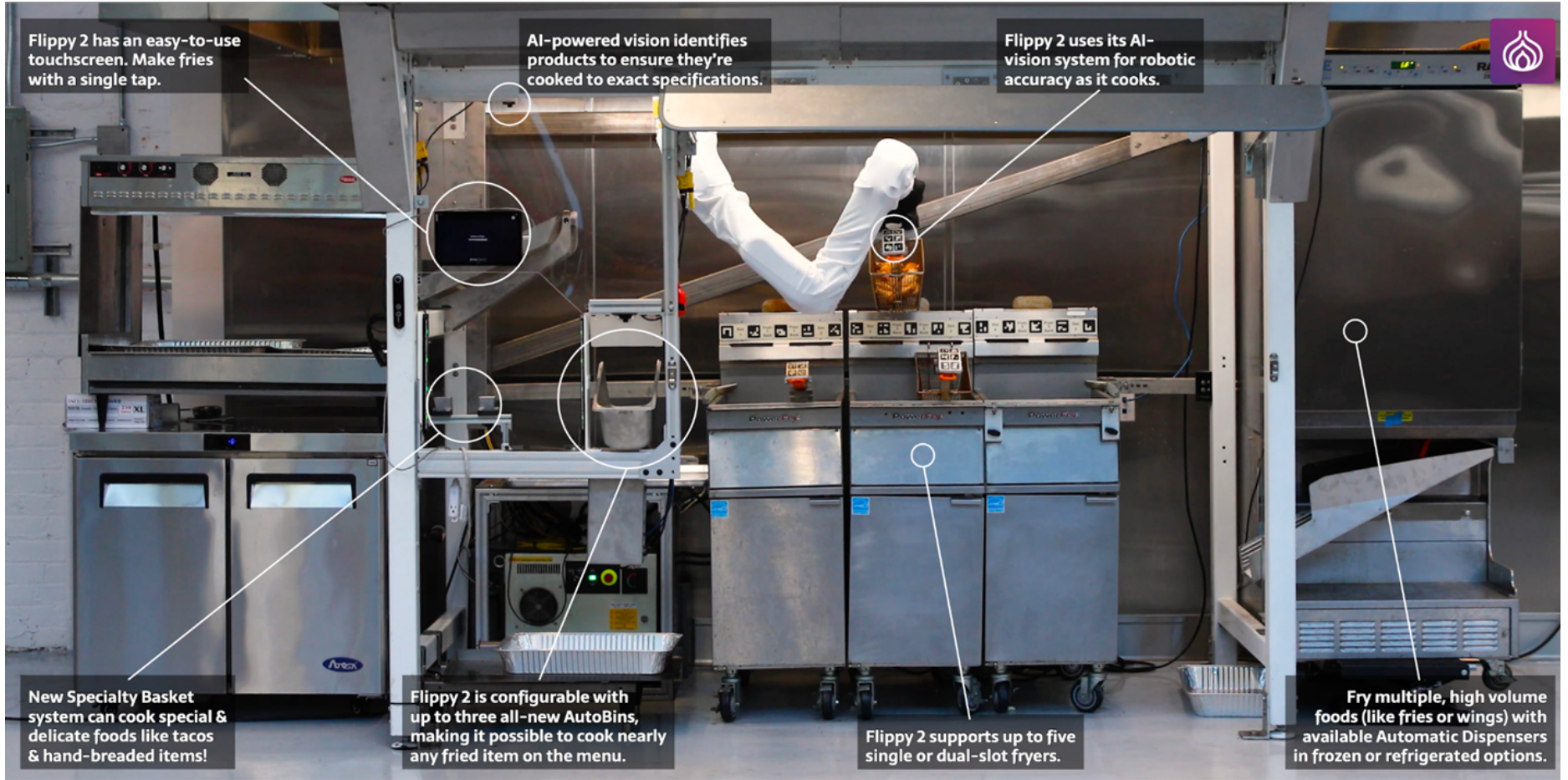

## SPACE REQUIREMENTS

Flippy needs just under **14 feet** of wall space to cook the food from start to finish. This includes everything (from right to left):

### IMPORTANT MEASUREMENTS

**Width** (*Hot Hold + Frame + Dispenser*): **13' 11.6" (167.6")**

**Height** (*Top of Frame*): **7' 11.6" (95.6")**

**Depth**: (*Wall to Front*): **5' 7.7" (67.7")**

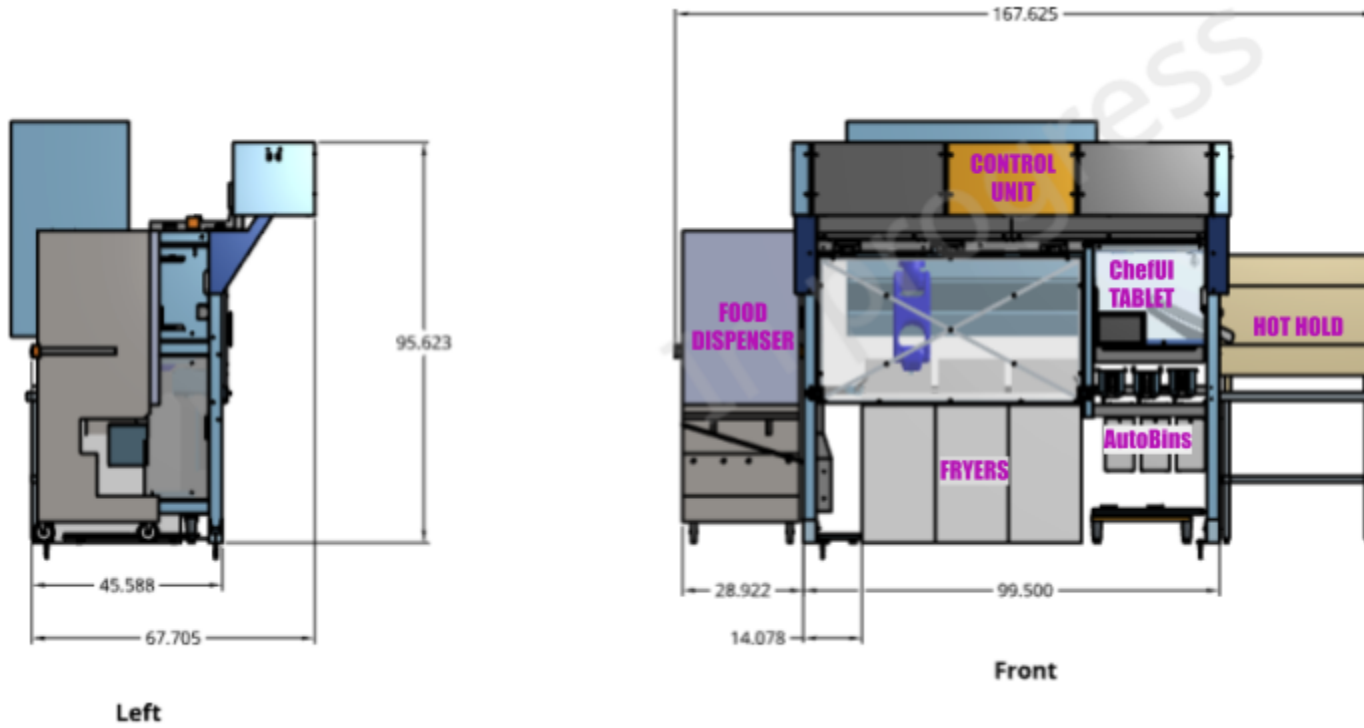

## CANOPY HOOD COMPATIBILITY

- Hood depth, 48 or 54" from Wall
- Make up air height from ground must be  $\geq 96"$
- Bottom lip of hood to ground must be  $\geq 77.5"$
- ANSUL Nozzles height in robot area must be  $\geq 70"$
- ANSUL Nozzles distance from front of hood must be  $\geq 20"$

**Miso Canopy Hood Compatibility Flippy 2.0.1 or Newer:**

#	Dimension	Value
1	Hood Depth	48 or 54" from Wall
2	Make Up Air Height From Ground	Must be $\geq 96"$
3	Bottom Lip of Hood to Ground	Must be $\geq 77.5"$
4	ANSUL Nozzles Height in Robot Area	Must be $\geq 70"$
5	ANSUL Nozzle Distance from Front of Hood	Must be $\geq 20"$

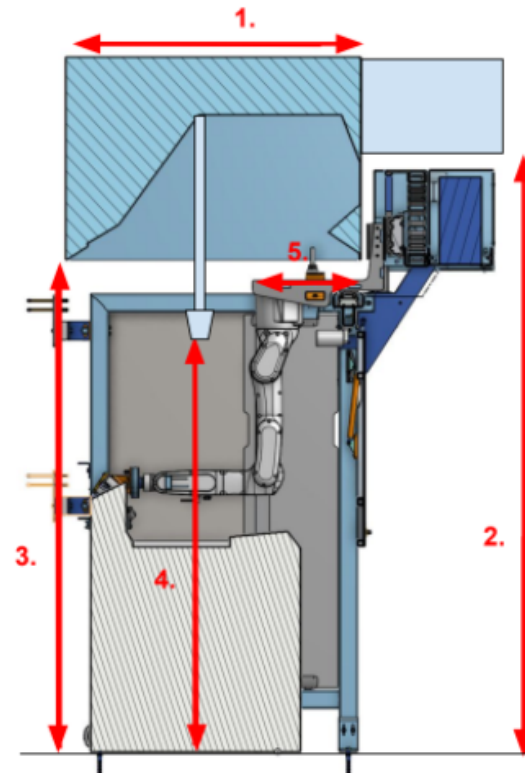

## MOUNTING REQUIREMENTS

Flippy needs to be mounted against the wall and anchored to the floor.

WALL:

→ Mounting is necessary at 4 different points within the frame, approximately 4" deep.

### WALL MOUNT 2X Side Frame

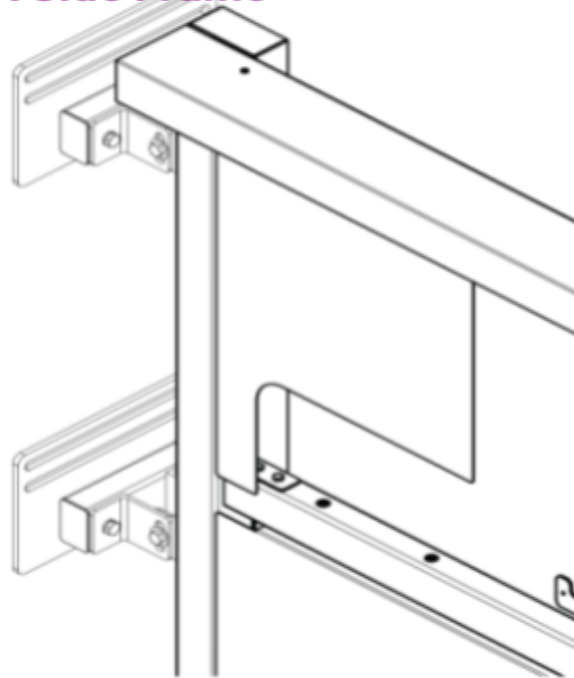

## FLOOR:

- Floor drilling is required in 4 different points that align to the feet of the side frames.
  - ◆ Holes will be drilled into floor with a  $\frac{5}{8}$ " diameter bit, approximately 4" deep.
  - ◆ There's 4 feet in total and these measure 3"x5.3"

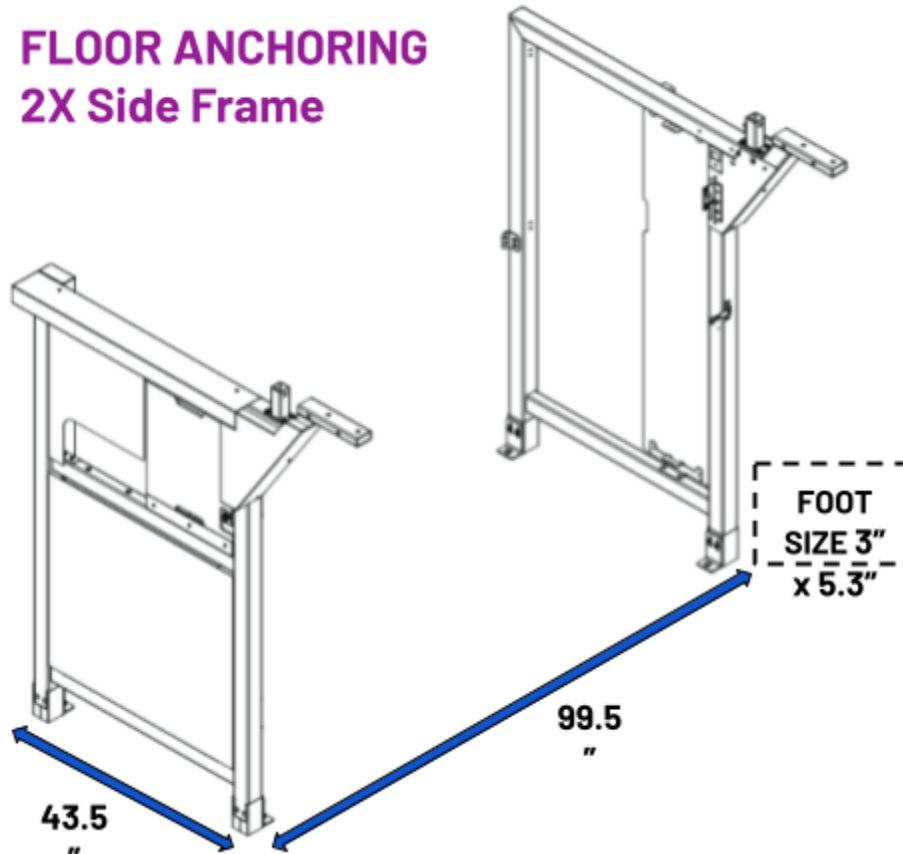



## POWER & ETHERNET PORT CONNECTION REQUIREMENTS

Flippy's individual components have different power needs. And in some cases, components will have to be on different circuits:

	COMPONENT	PLUG TYPE	AMP	MAX CORD LENGTH	RECEPTACLE
<b>A.</b>	Computer	120V	6A	<b>10' Power Cord</b>	NEMA 5-15P
<b>B.</b>	Robotic Arm	208V	5A	<b>10' Power Cord</b>	NEMA L6-20
<b>C.</b>	Food Dispenser	120V	8A	<b>6' Power Cord</b>	NEMA 5-15P
<b>D.</b>	Ethernet Port			<b>10' Cord</b>	

**In addition**, Flippy will need to be connected to an active Ethernet port.

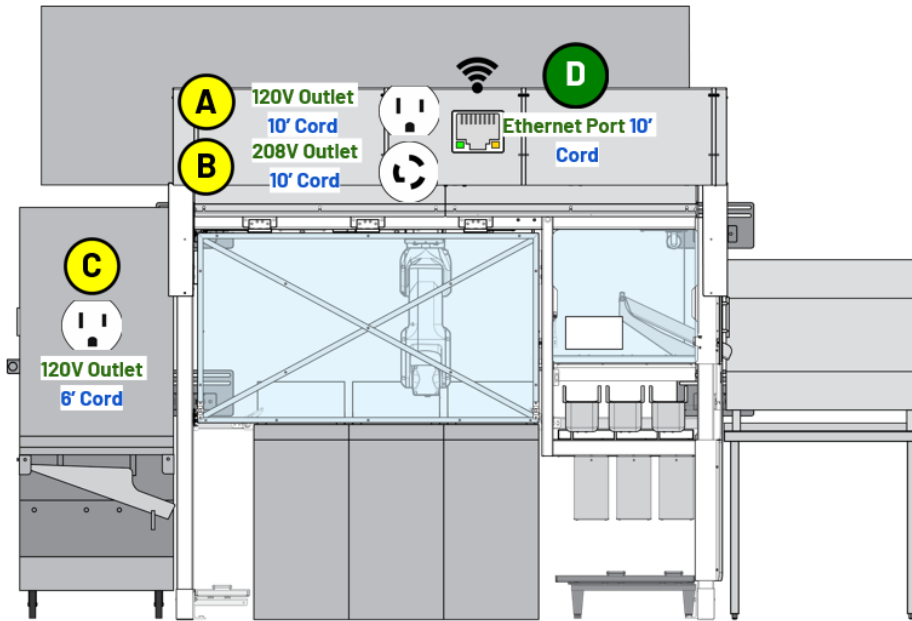

## NETWORK REQUIREMENTS

Miso Robotics, Inc. requires the following network access to set up and operate Flippy. Please ensure that there is unrestricted outbound access on your internet service.

→ Flippy will need access to the listed websites and ports:

Sites	Outgoing Ports	Reason
All	TCP: 443	SSL connectivity for package downloads, and cloud resources over many different IP ranges

github.com	TCP: 22	Access to private github repos
Forti VPN (35.203.163.51)	UDP: 1194,500,514,4500 ESP: (IP protocol 50)	VPN connectivity
Forticloud management <a href="#">As mentioned in Fortinet documentation.</a> 208.91.113.0/24 173.243.132.0/24 81.201.100.224/27 81.201.101.192/26	TCP: 80, 443, 541, 514	Router Management connectivity
1.1.1.1 8.8.8.8 8.8.4.4	ICMP: ping, TCP: 53, UDP: 53	Global DNS Resolution

→ Flippy requires an internet connection with a bandwidth of at least:

- 20 Mbps Download Speed
- 20 Mbps Upload Speed

- 220 GB of Data Transfer Per Day

**Procedure:** Verify with your internet service provider that you do not have data caps and that your internet supports the additional data Flippy will generate.

- **During the install, you will need to have someone onsite with network admin access. They will need to have the Username and Password for your Modem and Router.**

*These are supplied by your Internet Service Provider (ISP) and may be combined into a single device.*

*Please reach out to Miso Robotics if you experience any issues with these steps.  
[installations@misorobotics.com](mailto:installations@misorobotics.com)*

## FOOD DISPENSER SPECIFICATIONS

- Miso Robotics provides and maintains a modified Food Dispenser.
- Manufacturer: Taylor Company
- Model: [RAM R280](#)
- Specification Sheet: [Taylor Company R280 Specifications](#)
- Operators Manual: [Taylor Company R280 Operator Manual](#)

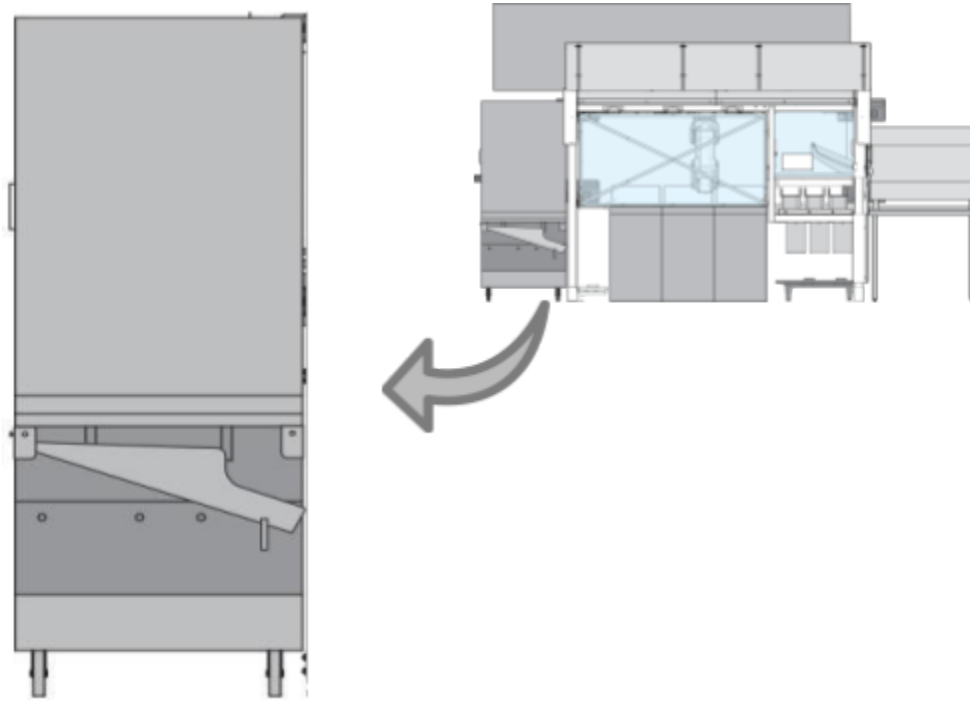

## HOT HOLD SPECIFICATIONS

- Miso Robotics **does not provide or maintain** the Hot Hold unit but recommends the Hatco Multi-Product Warming Station
- Manufacturer: [Hatco Corporation](#)
- Model: [MPWS-36](#)
- Specifications Sheet: [Hatco Multi-Product Warming Station Specifications](#)
- Operators Manual: [Hatco Multi-Product Warming Station Operating Manual](#)



→ The Hatco Hatco Multi-Product Warming Station has **accessories for an additional cost** that you can select at the time of ordering to customize and accommodate your workflow preferences

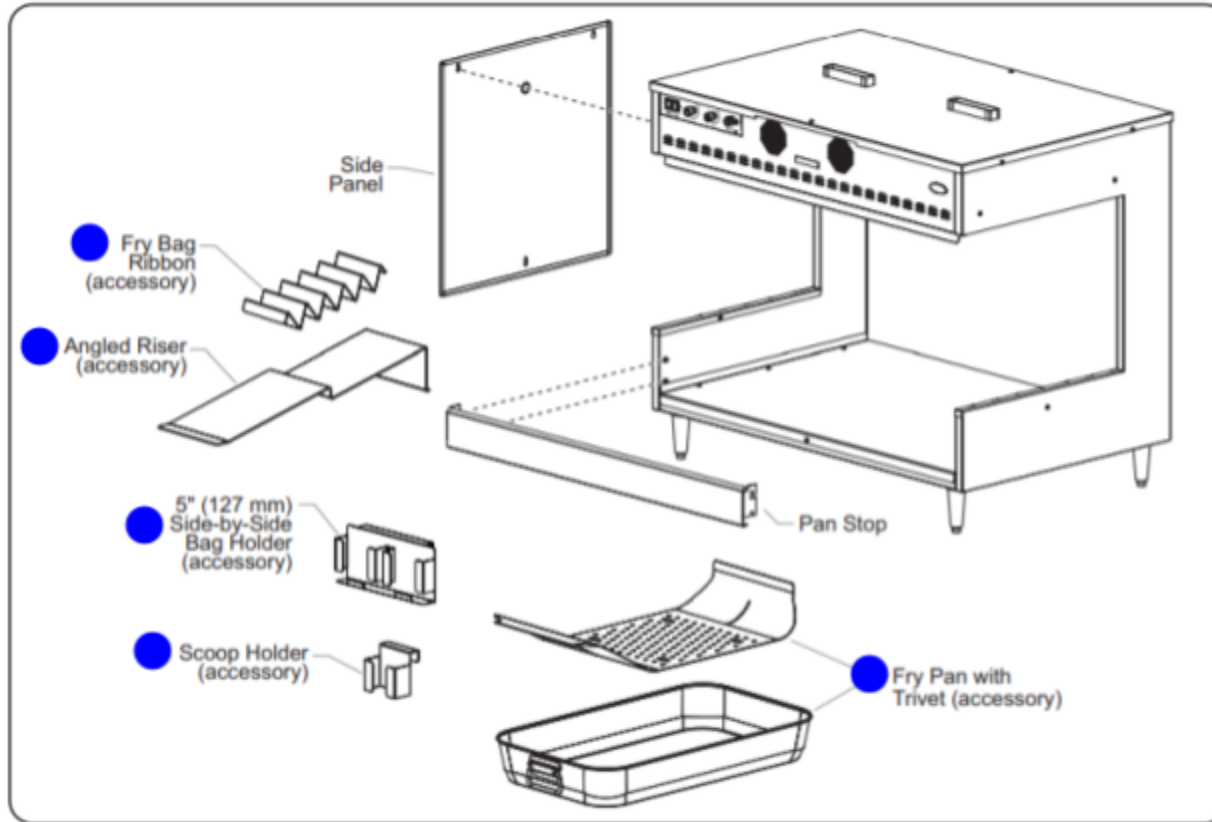

Components and Accessories





## HOT HOLD PLACEMENT REQUIREMENTS

- The Hot Hold unit container must sit below the Hot Hold Chute.
- The Hot Hold unit should have accessible sides for food entry.

